

UNSHIELDED SMD POWER INDUCTORS / FPI TYPE

FEATURES

- ◆ Silver Plated Type
- ◆ High power and high saturation
- ◆ Ideal inductors for DC/DC conversion



APPLICATIONS

- ◆ Power supply for VTRs.
- ◆ Portable communication equipment.
- ◆ Notebook PCs.
- ◆ LCD televisions.
- ◆ DC/DC converters, etc.

ORDERING CODE

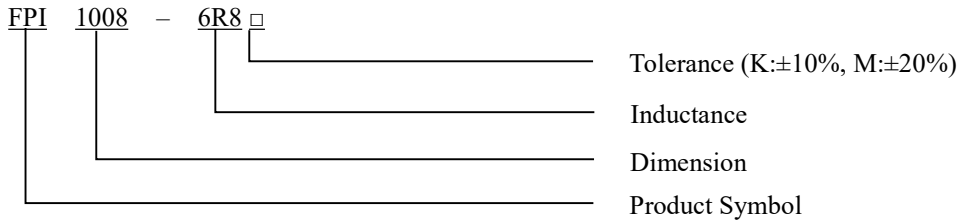

DIMENSIONS (UNIT: mm)

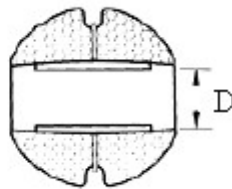
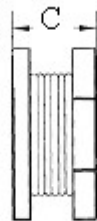
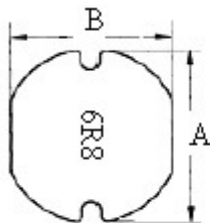

A	10.0 ± 0.4	m/m
B	9.0 ± 0.4	m/m
C	8.2 ± 0.3	m/m
D	3.1 (REF)	m/m



CORE MASTER ENTERPRISE CO., LTD.

<http://www.coremaster.com.tw>

UNSHIELDED SMD POWER INDUCTORS / FPI TYPE

ELECTRICAL CHARACTERISTICS FOR FPI1008

Part No.	Inductance (uH)	RDC (Ω)	IDC (A)
FPI1008-6R8 □	6.8	0.026	8.00
FPI1008-100 □	10	0.036	7.50
FPI1008-220 □	22	0.055	4.70
FPI1008-330 □	33	0.082	3.80
FPI1008-470 □	47	0.100	3.20
FPI1008-560 □	56	0.120	3.06
FPI1008-680 □	68	0.150	2.70
FPI1008-820 □	82	0.180	2.45
FPI1008-101 □	100	0.200	2.00
FPI1008-151 □	150	0.325	1.80
FPI1008-221 □	220	0.450	1.50
FPI1008-331 □	330	0.640	1.24
FPI1008-471 □	470	0.950	1.02
FPI1008-561 □	560	1.200	0.99
FPI1008-681 □	680	1.330	0.84
FPI1008-821 □	820	1.660	0.79
FPI1008-102 □	1000	1.980	0.76
FPI1008-122 □	1200	2.440	0.70
FPI1008-152 □	1500	2.990	0.65
FPI1008-202 □	2000	4.290	0.50
FPI1008-302 □	3000	6.000	0.45
FPI1008-402 □	4000	8.060	0.40
FPI1008-442 □	4400	8.300	0.32
FPI1008-104 □	100000	182.0	0.05

* 100uH 以上 Test Frequency : 1KHZ/1V

* 100uH 以下 Test Frequency : 2.52MHZ/1V



CORE MASTER ENTERPRISE CO., LTD.

<http://www.coremaster.com.tw>